

NOBLE PARK COMMUNITY CENTRE

By the community, for the community



ANNUAL REPORT

July 2021 - June 2022

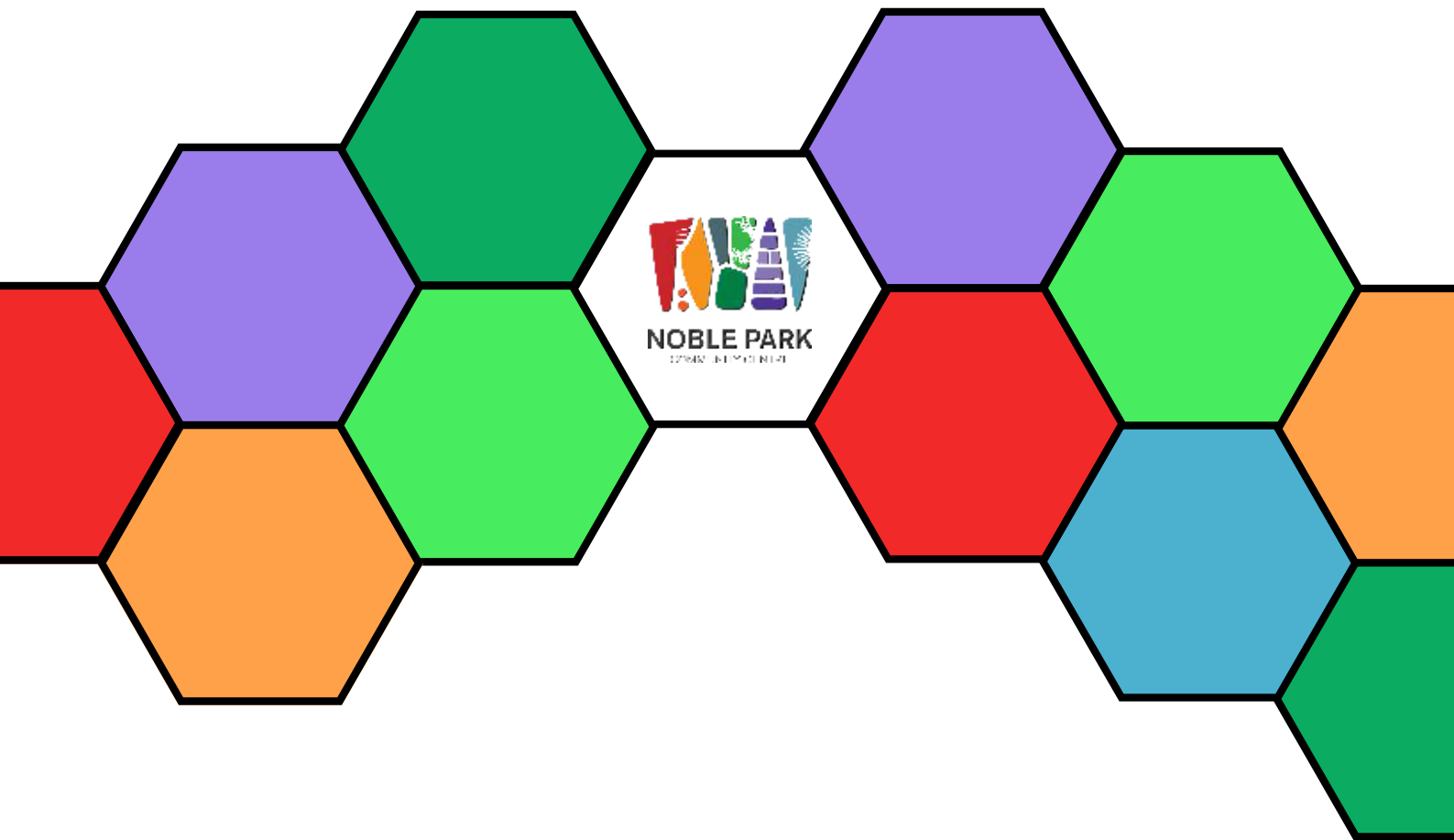

We acknowledge the Traditional Owners of country throughout Australia and recognise their continuing connection to land, waters and culture. We pay our respects to their Elders past, present and emerging.



CONTENTS

- 4 Who are we?
 - 6 Our Team
 - 9 President's Report
 - 10 Treasurer's Report
 - 11 Manager's Report
 - 12 What we do
 - 18 Facilities & Hiring Groups
 - 20 Acknowledgements & Partnerships
 - 21 Audited Financial Statements
- 

WHO ARE WE?



The Noble Park Community Centre Incorporated (NPCC) was established in 1956 to engage the local youth within Noble Park through recreational activities such as gymnastics, indoor bowls, and basketball. The aim was to provide a productive outlet and a sense of inclusion within their community.

More recently, NPCC has evolved into the “Hub” of the Noble Park Community, a place where people of all ages, backgrounds and abilities are welcomed. The range of programs and services provided reflect the changing needs of one of the most multicultural communities in the nation.

NPCC is a proud member of both Neighbourhood Houses Victoria (NHVic) and the Community House Network Southern Region (CHN). NPCC operates in a model of community development, social inclusion and community engagement with meaningful participation, guided by the ten Neighbourhood House Sector Principles:

1. Community ownership
2. Community participation
3. Empowerment
4. Access and Equity
5. Lifelong Learning
6. Inclusion
7. Networking
8. Advocacy
9. Self-help
10. Social Action

(NHVic website <https://www.nhvic.org.au/principles>)

OUR MISSION STATEMENT

To provide educational, recreational and social opportunities, services and support for people of all ages, abilities and interests, determined by the community according to its needs.

OUR VISION

Encouraging community spirit and diversity through social interaction.

WHO ARE WE?

Countries of birth

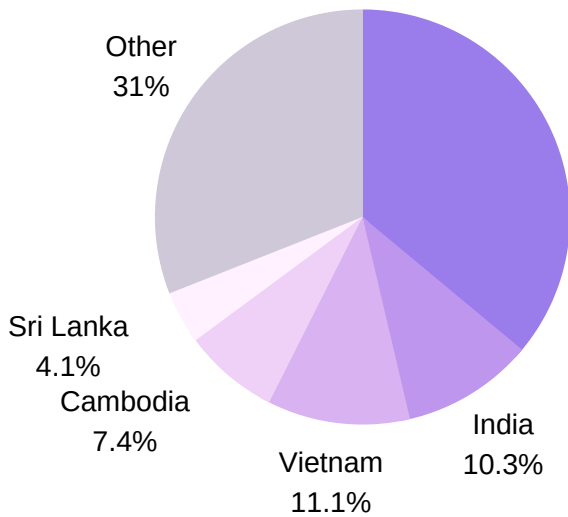

Languages spoken at home

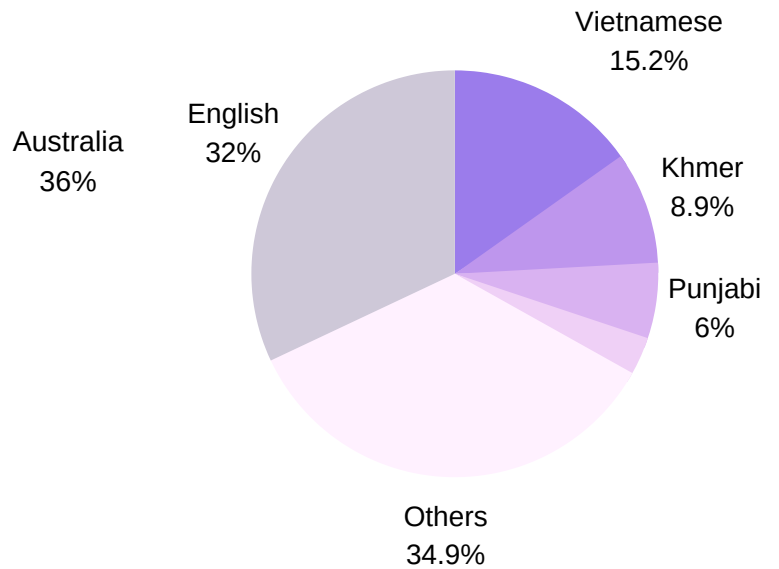

Employment

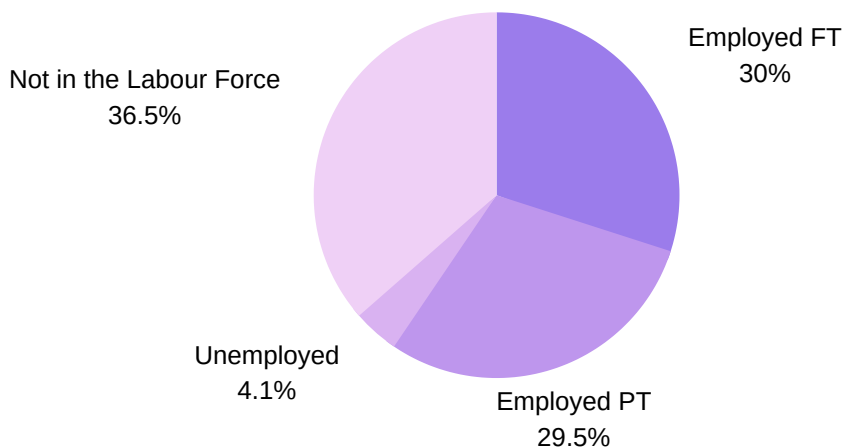

Ages

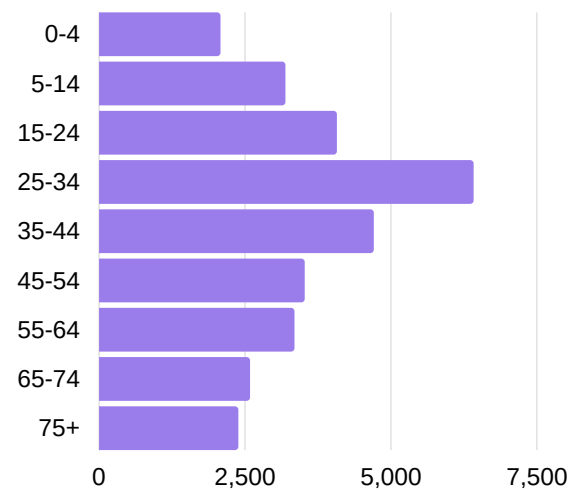

*Data from 2021 Census

OUR TEAM

GOVERNANCE COMMITTEE



Jan Trezise
President



Roz Blades
Vice President



Merial Clark
Treasurer



Heather Duggan
Secretary



Angela Holl
Ordinary Member



Lissette Brearley
Ordinary Member
(resigned 4 October 2021)



Gloria Kiri
Ordinary Member
(resigned 30 June 2022)



Geraldina Alvavez-Poblete
Ordinary Member



OUR TEAM

STAFF



Therese Kennedy
Manager

Elise Logan
Programs Coordinator



Shelly Kemp
Events & Facilities Coordinator

Rowena Garrett
Finance Officer



Anthony Galea
Drawing Tutor

Le Giang
Yoga Instructor



Soraya Yawari
Playgroup Facilitator

Rashmi Dutta
Yoga Instructor



Toshi Handa
All Abilities Art Tutor



OUR TEAM

VOLUNTEERS



Gaye Guest
Art Show Volunteer



Gloria Kiri
Conversational English Tutor



Ivan Gnoco
Garden Club Facilitator



Raymond Michael
Badminton Facilitator



Cecilia Goncalves
Knitting Group Volunteer



Rosalba Velardi
Art Show Volunteer



Pauline Stewart
Art Show Volunteer



John Bosdorf
Ramblers Walking Club Facilitator



Anthony Galea
Art Show Volunteer



Nebil James
Drop in Basketball Facilitator



Carmel Farr
Ramblers Walking Club Volunteer



Judy Moir
Ramblers Walking Club Volunteer

Bernadette Kennedy
Art Show Volunteer



Ian Stewart
Art Show Volunteer



PRESIDENT'S REPORT

There have been several highlights for our Centre throughout the year. Therese has now completed more than 12 months in the Manager's role. She continues to motivate staff, effectively network with leaders in the community, and bring her energy and enthusiasm to the Centre on a daily basis. As a result much has been achieved in the promotion of the Centre and all it has to offer to the local community. Programs have been developed in response to many identified needs as a result of Therese's effective networking.

Our Centre continues to take the lead in our municipality as the Centre for Art. Our print art and gardening programs continue to flourish. It is also great to see the many crossovers that are happening. For example: People who enjoy the community lunches now enjoying drawing, knitting, yoga, craft and /or gardening classes. The Art Show continues to grow with another one to be held in in October having us present 2 shows in a matter of 7 months presenting a major challenge. The Art Show held in March attracted an impressive number and range of entries, record numbers attended over the weekend, and a record number of art works were sold. Also many entries came from first time entrants. Thank you to all those who volunteered to work, under the competent leadership of Shelly.

The Governance Committee farewelled one member and welcomed another. Gloria Kiri was experiencing health issues so felt it necessary to resign. We had an afternoon tea to say thank you for her contribution. Recently we have welcomed Kathy Hopkins who brings with her valuable experience, enthusiasm, and knowledge. We have been on the lookout for additional members who can bring with them a range of competences, enthusiasm and local knowledge. It is pleasing and reassuring to know that there are a few additional members of the community who are considering becoming involved at the Governance Committee level.

It has been pleasing to see the many improvements to the Centre, that have been funded by the State Government through the Noble Park Revitalisation Board, materialise throughout the year. Of particular note is the way the Community Garden and surrounds has been transformed. New seating under branded umbrellas, old shedding replaced by attractive storage units, additional signage and attractive fencing which features welcoming notice boards. Thank you Roz and Therese for following through on the implementation of the improvements funded by the Noble Park Revitalisation Board. Thank you also for our local member of parliament Lee Tarlamis, who chaired the Board through this consultation process and has demonstrated an ongoing interest in our Centre

The final highlight to mention is the 'NPCC Blue Print for the Future' consultation process that was also funded by the Noble Park Revitalisation Board. In partnership with CoGD staff, led by Bilijana Komnenovic, our Governance Board members and staff were guided by an effective consultant through a process of review and renewal. The local community was encouraged to have their say about the role the Centre plays and how it could better meet emerging needs. All aspects of the Centre were scrutinised including governance, staffing, financial sustainability, and the development of concept plans for the future improvements to the building and facilities that will be needed. Having accepted the challenge of the process to produce a blueprint for the future, the NPCC can look forward with confidence knowing that it has reviewed all the elements that make up an effective community centre.

Community development, which is the additional element that ensures a community centre is dynamic and owned and embraced by the community, is now happening in our Centre. Effective community development takes time and requires a commitment by the Governance Board members and the staff. We can all look forward to seeing this vital element become embedded in every aspect of the Noble Park Community Centre.

Jan Trezise

TREASURER'S REPORT



The audit report has been prepared by APL Financial Pty Ltd who have expressed the opinion that the report presents a true and fair view of the financial position of Noble Park Community Centre (NPCC) as at 30 June 2022.

The income of NPCC for the year, before any COVID19 Government Funding, was \$329,658 compared to \$267,339 to 30 June 2021, an increase of \$62,319. This increase in income is mainly reflected in an almost doubling of Program & Activity Fees from \$13,304 to \$24,570 as the centre was able to open from October 2021 onwards; plus a significant increase in Room Hire. This item was added as an income account for the reporting period, separating it from Function Hire (hall hire over weekends). Function hire (which included room hire) to June 2021 was \$50,185 and for this reporting period total function and room hire was \$62,245, an increase of \$12,060. Additionally, project income of \$41,400 was received from the state government – the Noble Park Revitalisation Board - for our Community Engagement Project.

The final Victorian Government Business Support Funding, paid over the months of July, August and September 2021 when COVID closures occurred, provided an important additional \$50,400 to our income.

The year's operating expenses totalled \$412,800 compared to \$390,786 to 30 June 2021, an increase of \$22,014 - mostly due to increased spending on program & workshop materials and advertising.

NPCC recorded a loss for the year of \$32,742, with retained members' funds now sitting at \$158,015 (down from \$190,757 for the previous year). Last year I reported that the NPCC committee committed to investing \$50,000 of retained earnings to community re-engagement activities in the 2021-2022 year; this loss represents NPCC increasing engagement with the community over the year.

It was with some disappointment that we accepted Rowena Garrett's (the NPCC Finance Officer) resignation at the end of the financial year. I would like to sincerely thank Rowena for her expertise and professionalism. Her excellent administration of the accounts has enabled effective reporting to the committee, making my work as Treasurer stress-free. We all wish Rowena success and satisfaction in her new position. I would then like to warmly welcome Bianca Durainayagam (who commenced after the end of this reporting period); she comes to us with sound Neighbourhood House financial experience.

My thanks also to the commitment and dynamic work of Therese Kennedy, Centre Manager and the dedicated staff and tutors she manages; the team have supported the NPCC community with care and sensitivity. I would also like to extend my thanks to both the Networkers of the Southern Community Houses Network Cath Darcy and Wendy Hiam for their support and advice.

Finally, I wish to extend my thanks to the members of the NPCC Governance Committee for their strategic oversight of the governance of the organisation. I would particularly like to acknowledge the leadership of our President Jan Trezise as she stands down from the committee after serving for three years. Thank you all for your active participation.

Merial Clark



MANAGER'S REPORT

The 2021-2022 year was off to a good start with us being opened, unfortunately we experienced 2 more lockdowns resulting in the Centre being closed for a further 89 days. The good news is we opened the doors again on the 21st of October and have remained opened ever since!

Our many programs and projects recommenced using a flexible and supportive approach. People attended in person or via zoom or a mix of both. People were excited to be able to get out and reconnect in a safe, friendly, and welcoming environment.

We learnt to live with COVID and implemented the 'Let's do our part campaign' keeping everyone safe from colds, flu and COVID'. Programs steadily grew in numbers and projects recommenced; you will see more about those later in the annual report.

Our funding bodies, project partners and key stakeholders were fantastic support being flexible to assist us in achieving outcomes for our community. It was good to be able to reengage people prior to Christmas. In the new year we were able to really kick off and enjoy the warmer months. People were keen to get to the centre and get active. We were able to deliver a wide range of indoor and outdoor activities through many and varied forms of funding including Department of Families, Fairness and Housing (DFFH), Department of Jobs, Precincts and Regions (DJPR) - Noble Park Revitalisation Board Projects, Adult Community & Further Education (ACFE) and City of Greater Dandenong (CGD) Grants. We cannot forget many others who sponsor and support us throughout the year including other Not-for-profit organisations, trusts, private business and individuals. We also received many donations of food and material aid items to help people during the difficult times. Every little bit helps to support our community.

In March we held our Art Show which was highly successful with the most entries and visitors attending ever. We look forward to holding our next one in October.

We will continue to keep our community well supported and connected and look forward to enjoying the indoor and outdoor upgrades to the Centre.

A huge thank you to the staff, tutors, and volunteers for all their work throughout the year in keeping people connected and safe. A special mention and thanks also to the Committee who have volunteered many hours throughout the year in helping us achieve our goals.

Therese Kennedy

WHAT WE DO

Drop in Basketball

This year we decided to partner with Reclink Australia to work together to continue to deliver this free program that allows older youth aged 16 and up to participate in friendly games of basketball each Monday night from 4:30pm-7pm. Many attendees are unable to join a typical sporting club due to employment, family, and economic constraints. This activity provides a positive outlet to participate in a sport they enjoy and excel.

Gentle Exercise

In May 2022 we partnered with Reclink to deliver free Gentle Exercise class on Wednesday mornings. These are fitness classes for people that may not be steady on their feet but would like to keep fit. It has been so greatly successful that we began an advanced class on a Tuesday.



Art Classes for Kids

Commencing Term 2, 2022 Art Classes for kids was designed for children ages 6-8 to release their inner artist by designing and creating masterpieces using traditional and non traditional mediums.

Yoga

Our Yoga classes are held on Tuesday & Thursday mornings. Classes focus on making yoga accessible for the vulnerable audiences that may lack confidence or skill to join a mainstream class. Our facilitators aim to create a calm and relaxed safe space, including modified poses and movements to ensure each student receives the most from each class.



WHAT WE DO

Ramblers Walking Club

The Ramblers Walking Club is currently co led by volunteers John Bosdorf and Carmel Farr, with Judy Moir assisting. The Ramblers have over 60 members between the ages of 50-94. Each Tuesday from 9am-11am the group meets to walk the local neighbourhood and on their return enjoy a social cuppa. Once a month the group also organises a bus trip to a new destination within Victoria to visit and explore.



Cheeky Little Monkey's Playgroup

Our Playgroup is open to all community members with preschool aged children. We focus on educational play whilst encouraging guardians and caregivers to forge friendships and share experiences. Playgroup is held on Tuesdays from 1:30pm-3:30pm, during the school terms.

Knitting Group

Our growing group of knitters get together once a week on a Tuesday morning to socialise, knit and share their knowledge. They knit or crochet items such as blankets, hats, scarves, clothes and teddy's using wool donated by the community.



Home Grown Swap

Our monthly Friday Swap Meets are an opportunity for members of the community to come and swap their home grown goods such as fruit, vegetables, herbs, and cuttings. Sometimes community members will also swap jams, recipes, jars and worm juice. Everyone shares stories and knowledge on how they grew their items, sustainable living, and other gardening advice. It's a fusion of know-how, expertise and contribution.

WHAT WE DO

Social Tai Chi

Our original members started many years ago as a class and still come every Friday morning to practice routines together guided by an instructional DVD. Our participants love to come together after each session to socialise and enjoy a cuppa.



Noble Park Revitalisation Board

NPCC received three major projects focusing on physical improvements, community engagement activities and the creation of a business plan for the future.

You can now visit NPCC to enjoy the new outdoor spaces, upgraded indoor areas and to participate in various activities for people of all ages and abilities. Funding is provided by the Victorian Government through the Noble Park Revitalisation Board in partnership with City of Greater Dandenong.



Intergenerational Learning

This year allowed us to continue our intergenerational learning project in person rather than via zoom. We expanded our arts and crafts activities however looming continued to be a favourite. Gardening, cooking and educational games were also implemented as part of the project and was a fantastic and fun way to bring people of all ages and abilities together.

WHAT WE DO



Garden Club

The Garden Club meets every Friday morning where they work in the Community Garden, sharing knowledge, maintaining the garden, and experimenting with new plants and growing methods. The gardeners enjoy a cuppa and a chat after each session in the foyer where they enjoy mingling with other groups that are there at same time. Many of the members have gardens at home but enjoy the social part of the Garden club as many live alone.

All Abilities Art & Craft

This class, held on Fridays is for people with a disability, focused on giving learners motivation and confidence through art. The aim of the class is to create an environment where learners have the autonomy to use their own ideas, and self-determination to create something with joy, whilst building independence at the same time.



Community Lunch

We were extremely happy to welcome back the Community Lunch in May 2022. Hosted and catered by Servants of the Two Hearts and Reaching Out Because We Can this weekly lunch is held each Tuesday where members of the community are provided with a delicious hot meal. Volunteers are also on hand to provide referral services and material aid to those in need.



Drawing Classes

We have a number of evening & afternoon drawing classes for adults and children ages 8 and up. Our tutor Anthony Galea tailors classes to ensure that whether you are an experienced artist or just learning the basics, each student learns something new each time they attend.

WHAT WE DO

Art Show

Originally to be held October 2021, we were unable to go ahead as planned due to another lockdown so we decided to move the show to March 2022 instead of missing out on this fabulous event yet again.

The community returned to the show in record numbers. Over 162 artists entered a total of 463 pieces, making it our largest exhibition to date. Over the weekend we also had a record 661 people attend and view the artwork.

Thank you to all of our sponsors, without them this event would not be possible. Finally congratulations to all of our entrants and award recipients, especially Bendigo Bank 1st Prize Open Winner Do Noble with his piece *Mystical Evening*.



Badminton

Badminton runs every Monday evening from 7:30am-10pm, headed by volunteer facilitator Raymond Michael. This low cost activity has been a part our community for over 15 years. Players engage in friendly matches each week to build on their skills and fitness.



Workshops

We ran a number of free workshops over the year including art, gardening & recycling. These are a good starting point for the community to come and get to know who we are and what we do.

WHAT WE DO

Art Trail

In the lead up to the 2021 Art Show we curated a self guided tour throughout Noble Park and surrounding suburbs, to explore some of the most talented local artists, and some of the best art this municipality has to offer. Although the upcoming show will be postponed we are excited that our patrons will continue to enjoy outstanding pieces of art leading into next year.

Due to its amazing success we will continuing the Art Trail through until our next Art Show in October 2022.



Artist in Residency

This opportunity funded by the Noble Park Revitalisation Board (NPRB) allowed us to select artist Anthony Galea to create piece of work at the NPCC from conception through to completion.

A workstation was be set up within the Centre where visitors were able view his processes and techniques as Anthony worked, whilst allowing the community to engage and interact with the him. The final piece is set to be completed for the 2022 Art Show.



FACILITIES & HIRING GROUPS

- Afri-Aus Care Inc.
- APM Employment Services
- An-Nur Foundation Inc.
- Ardent Owners Corp Managers
- Australian Multicultural Community Services
- Basketbol At Kulturang Pinas Inc
- Bayside Strata
- Bluebelles Volleyball Club Inc
- Chanh Dao Buddhist Youth Association Inc
- Chisholm Institute
- Cook Islands Community
- Darfur Community Association of Australia
- Department of Families, Fairness & Housing
- Divine Restoration Church
- Elite Volleyball Academy
- Employease
- Extended Families
- Gabriel Nitura Basketbal
- Greater Dandenong Chamber of Commerce
- Greater Dandenong Youth Services
- Helping Hoops Inc

- Hungarian Senior Citizens of Greater Dandenong Inc
- I Millions Management56 PTY LTD
- Imam Hussain Association
- Istrian Social Club Ucka Inc
- Italian Elderly Citizens Club Noble Park Inc
- Japan Karate Association - Noble Park
- Keyzpark Calisthenics Club Inc
- Kids Corner Family Day Care
- Neami National
- Reclink
- Servants Reaching Out
- South East Community Links
- Springvale Neighbourhood House Inc
- STEMBuddy Coding & Robotics Education
- Stirling Institute of Australia
- Sudanese Arabic Language School
- The Bridge Inc
- Valid Inc
- United Karate Systems
- Xinjiang Chinese Association of Australia Inc
- Your Day Support Services

Centre Use by day

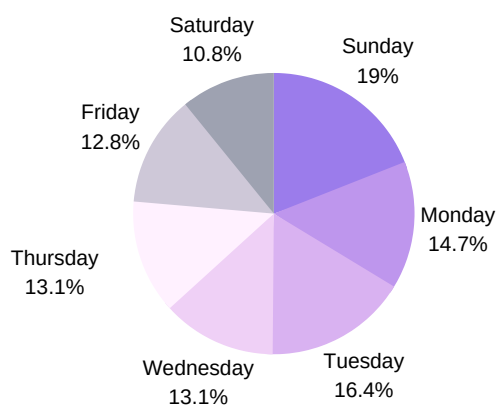

Centre use by room

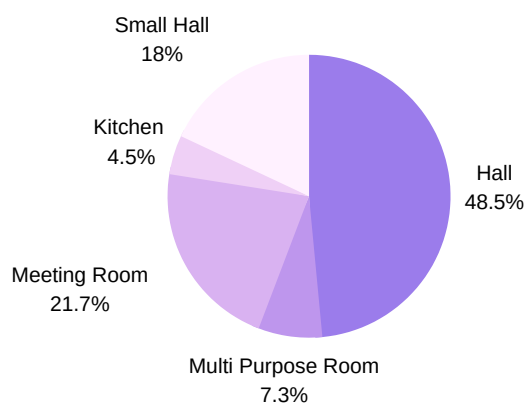

FACILITIES & HIRING GROUPS



856

people attend the centre each week*

67

groups &
individuals
hired our
facilities



Top
5

5. Employease
4. Istrian Social Club Ucka Inc
3. Italian Elderly Citizens Club Noble Park Inc
2. Springvale Neighbourhood House Inc
1. Keyzpark Calisthenics Club Inc

193 hrs
202hrs
208 hrs
372 hrs
547 hrs

105

average hours used
per week*



3705

hours used*



19

functions

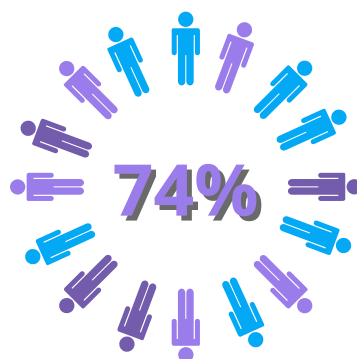

hirers were
community
groups

*Inclusive of Centre run programs and activities

ACKNOWLEDGEMENTS & PARTNERSHIPS

Thank you to our funding bodies, community members, groups, participants, local businesses & organisations who have had a part in shaping our Centre this year. A special thank you the following groups, individuals and organisations that have enriched and supported our Centre in some way, your contribution has not gone unnoticed.

- Adult Community & Further Education (ACFE)
- Bendigo Bank Dingley
- City of Greater Dandenong
- Club Noble
- Community Connections Network - Greater Dandenong
- Community House Network Southern Region (CHN)
- Department of Families, Fairness & Housing (DFFH)
- Department of Social Services (DSS)
- Department of Jobs, Precincts & Regions (DJPR)
- Dixon House
- Each Australia
- Emerson School
- Enliven
- Isobel Hamill
- Noble Park RSL
- Neighbourhood Houses Victoria
- Noble Park Public Hall Trust
- Noble Park Revitalisation Board
- Ray White Noble Park
- Reaching Out Because We Can
- Reclink Australia (South East)
- Rotary Club of Berwick
- Sandown Greyhounds Racing Club
- Servants of the Two Hearts
- Share the Dignity
- Spring Parks Primary School
- Springvale Community Hub
- Springvale Neighbourhood House
- The Band Booth
- The Bridge
- Valid
- Wellsprings for Women



AUDITED FINANCIAL STATEMENTS

Prepared by APL Financial Pty Ltd



Statement of Financial Position

Noble Park Community Centre Inc

As at 30 June 2022

Assets	30-Jun-22	30-Jun-21
Current Assets		
Cash and Cash Equivalents	257,907	233,528
Other Current Assets		
Accounts Receivable	16,382	9,044
Art Show Cash	-	135
Total Other Current Assets	16,382	9,179
Total Current Assets	274,288	242,706
Non-Current Assets		
Property, Plant and Equipment	14,132	17,175
Total Non-Current Assets	14,132	17,175
Total Assets	288,420	259,881
Liabilities	30-Jun-22	30-Jun-21
Current Liabilities		
Trade and Other Payables	21,996	14,361
Employee Entitlements	26,209	14,136
ACFE Unearned Income Provision	-	15,000
Unspent Grant Income	43,818	-
Total Current Liabilities	92,024	43,497
Non-Current Liabilities		
Annual Leave Provision	11,115	4,621
Bonds	6,571	5,000
Long Service Leave Provision	20,696	16,006
Total Non-Current Liabilities	38,382	25,627
Total Liabilities	130,405	69,125
Net Assets	158,015	190,757
Equity		
Current Year Surplus (Deficit)	(32,742)	93,531
Retained Earnings	190,757	97,226
Total Equity	158,015	190,757

Statement of Profit or Loss

Noble Park Community Centre Inc
for the year ended 30 June 2022

Income	2022	2021
ACFE Enrolment Fees	-	55
ACFE Fee Concession	-	19
ACFE Program Funding	15,000	15,152
ACFE Training Delivery Support Grant	-	5,500
Bank Interest	53	114
CoGD Community Project Partnership Grants	65,875	71,500
CoGD other grant	3,000	2,000
CoGD recurrent	-	11,901
Donations	331	200
Entry Fees	1,468	-
Function Hire	16,831	50,185
Fundraising	1,036	-
Grants Other	11,364	7,000
NHCP recurrent	89,596	86,909
Other Income	54	1,227
Program & Activity Fees	24,570	13,304
Partnership Projects	47,177	-
Room Hire	45,414	-
Sponsorship	4,209	2,273
Art Show Sales	3,679	-
Total Income	329,658	267,339
COVID-19 Government Funding	50,400	216,978
Gross Income	380,058	484,317

Expenditure	2022	2021
Depreciation	10,076	8,588
ACFE Program	6,333	-
Advertising & Promotion	9,891	896
Audit Fees	3,800	5,613
Bank (Stripe Fees)	215	34
Bank Fees	750	526
Centre Consumables	4,252	1,640
Cleaning Contractor	22,365	19,246
Computer Expenses	5,060	8,302
Consultants	2,000	-
Electricity	10,365	8,557
Equipment Purchase	2,691	1,156
Event Costs, Catering & Materials	5,597	75
Fundraising Expenses	870	-
Gas	764	764
Insurance	1,299	914
Memberships and Subscriptions	1,278	873
Photocopier Lease & Maintenance	1,642	1,642
Portable Long Service Leave Authority	2,246	2,028
Postage & Courier Expenses	638	58
Printing	2,562	600
Program & Activity materials	12,875	2,278
Property Consumables Repairs & Maintenance	6,019	3,613
Reimburse Staff Expenses	-	69
Salaries & Wages - Annual Leave	6,494	1,067
Salaries & Wages - Long Service Leave	4,690	9,012
Salaries & Wages - Recruitment Expenses	395	-
Salaries & Wages - Teachers & Tutors	17,033	22,363
Salaries & Wages Workers Compensation/Workcover	2,511	2,945
Salaries and Wages	207,880	234,654
Salaries and Wages - Consultancy	15,615	28,343
Security	290	150
Staff Training & Development	176	199
Stationery	828	112
Sundry/Miscellaneous Expenses...	3,277	3,152
Superannuation	22,592	15,594
Telephone and Internet	5,334	3,423
Website & Social Media	2,071	1,854
Workshops	4,029	450
Art Sales	3,505	-
CoGD NPCC Rent	283	-
Art Prizes	2,209	-
Total Expenditure	412,800	390,786
Current Year (Loss)/Surplus Before Adjustments	(32,742)	93,531
Net Current Year (Loss)/Surplus After Adjustments	(32,742)	93,531

A printed copy of the Audit Report from APL Financial Pty Ltd is available upon request or can be found at www.nobleparkcommunitycentre.org.au/about-us/annual-general-meeting



NOBLE PARK COMMUNITY CENTRE INC

Memorial Drive, Noble Park, VIC 3174 | 03 9547 5801

info@nobleparkcc.org.au

www.nobleparkcommunitycentre.org.au

ABN: 91 456 978 047



@nobleparkcommunitycentre



@noblepark_cc



NobleParkCommunityCentre



NOBLE PARK
COMMUNITY CENTRE